



# Church Lane

Town Centre, Northampton

oriordanbond  
LETTINGS



FIRST FLOOR  
422 sq.ft. (39.2 sq.m.) approx.

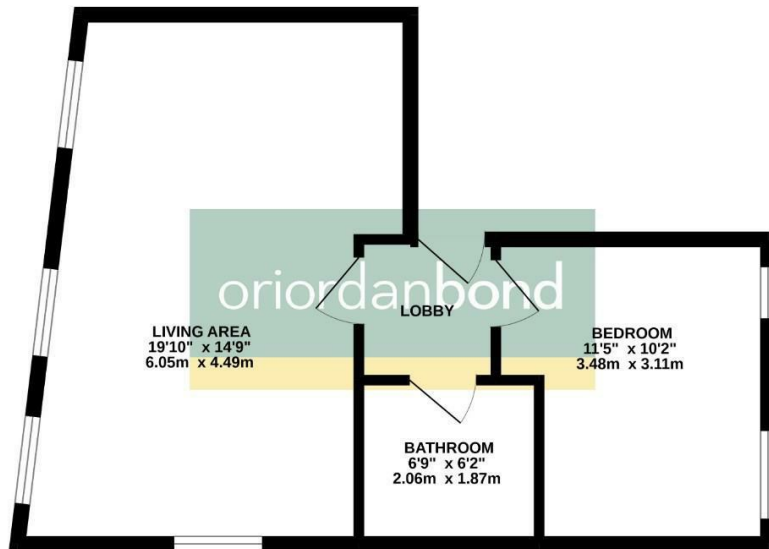

TOTAL FLOOR AREA : 422 sq ft. (39.2 sq m.) approx.  
Whilst every attempt has been made to ensure the accuracy of the floorplan contained here, measurements of doors, windows, rooms and any other items are approximate and no responsibility is taken for any error, omission or mis-statement. This plan is for illustrative purposes only and should be used as such for any prospective purchaser. The services, systems and appliances shown have not been tested and no guarantee as to their operability or efficiency can be given.  
Made with Metropix 02022

## Church Lane

Town Centre

NN1 3NL

£875 PCM

This superb first floor apartment offers contemporary style sitting/dining/kitchen with some integrated appliances, wine cooler and luxury bathroom. Benefits to the apartment include mood lighting, Haverland energy efficient radiators, oak doors, high speed full fibre optic connection point for superfast broadband, option for Sky point and high pressure hot water systems and colour video entry system.

### Tenancy Information

- Deposit: £1009.00 (1 Week Holding Deposit - £201.00)
- Smokers: Not Allowed
- Unfurnished
- Length of Tenancy: 12 Months
- Available: Mid July 2023

### Additional information

- Council Tax Band: A
- Energy Efficiency Rating: D

### Viewing

Viewing strictly by appointment – details below

### Disclaimer

O'Riordan Bond Estate Agents Limited has not tested apparatus, equipment, fittings or services and so cannot verify they are in working order. The buyer is advised to obtain verification from their solicitor or surveyor.

O'Riordan Bond Weston Favell Lettings  
01604 814400

lettingswestonfavell@orioridanbond.co.uk

